

PRODUCTION PLANT - 2nd LEVEL
(SCALE: 1:500 mm)

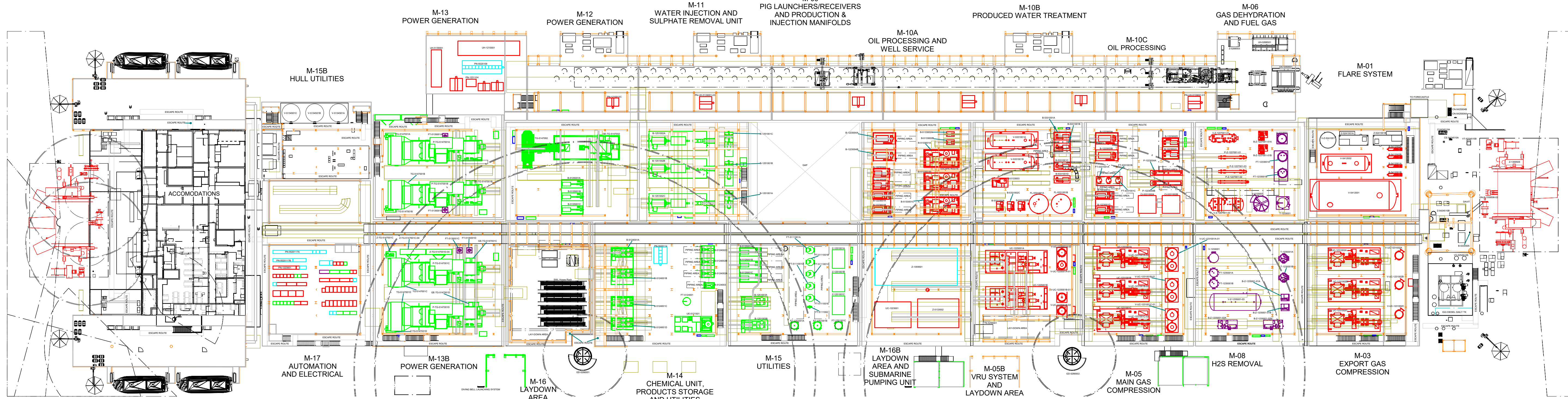

PRODUCTION PLANT - 1ST LEVEL (EL.39800)
(SCALE: 1:500 mm)

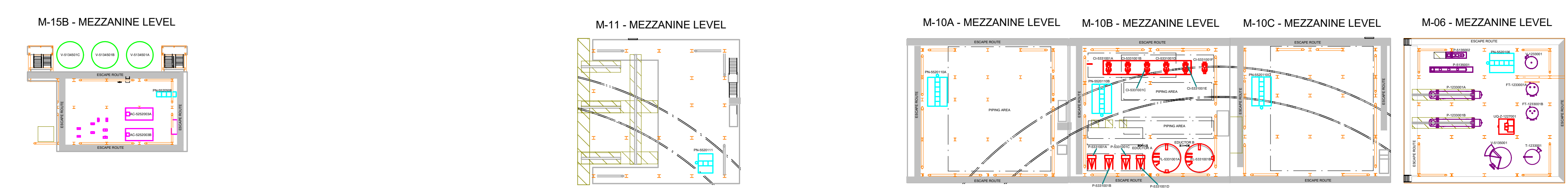
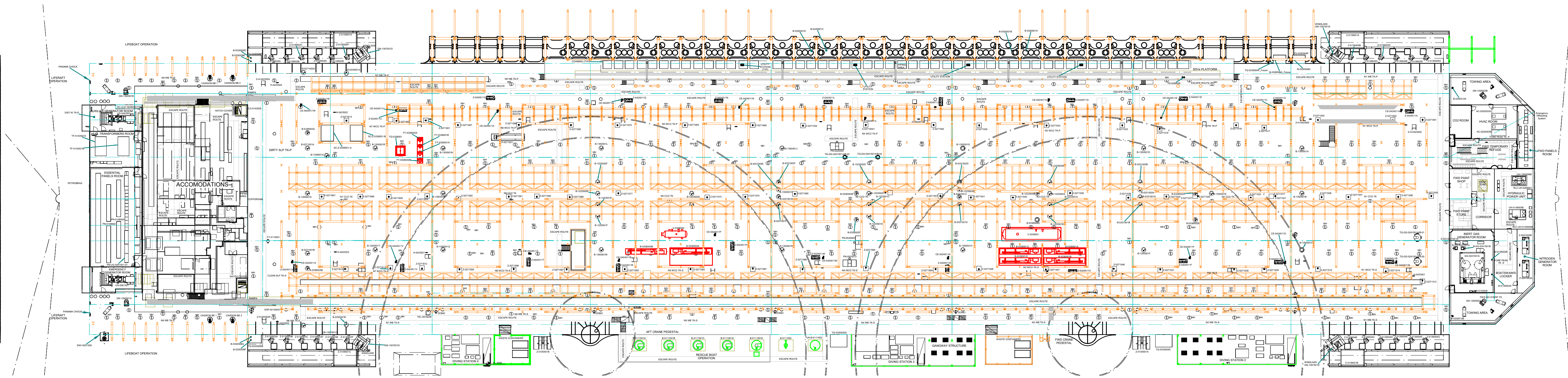

MAIN DECK (EL. 34300 AT CENTERLINE)
(SCALE: 1:500 mm)

MODULE TAG	MODULE DESCRIPTION
M-01	FLARE SYSTEM
M-03	EXPORT GAS COMPRESSION
M-05	MAIN GAS COMPRESSION
M-05B	VRU SYSTEM AND LAYDOWN AREA
M-06	GAS DEHYDRATION AND FUEL GAS
M-08	H2S REMOVAL SYSTEM
M-09	PIG LAUNCHERS/RECEIVERS AND PRODUCTION & INJECTION MANIFOLDS
M-10A	OIL PROCESSING AND WELL SERVICE
M-10B	PRODUCED WATER TREATMENT AND TEST SEPARATOR
M-10C	OIL PROCESSING
M-11	WATER INJECTION AND SULPHATE REMOVAL UNIT
M-12	POWER GENERATION
M-13	POWER GENERATION
M-13B	POWER GENERATION
M-14	CHEMICAL UNIT, PRODUCTS STORAGE AND UTILITIES
M-15	UTILITIES
M-15B	HULL UTILITIES
M-16	LAYDOWN AREA
M-16B	LAYDOWN AREA AND SUBMARINE PUMPING UNIT
M-17	AUTOMATION AND ELECTRICAL

REFERENCE DOCUMENTS

H-1-3010.2Q-1200-940-P4X-002 - EQUIPMENT LIST

GENERAL NOTES

- 1 - DIMENSIONS ARE IN MILLIMETERS, EXCEPT WHERE INDICATED.
- 2 - EQUIPMENT DIMENSIONS ARE PRELIMINARY.
- 3 - CONTIGUOUS INTERCONNECTION BETWEEN MODULES, MODULES/ACCOMMODATIONS AND MODULES FORECASTLE SHALL BE PROVIDED AT THE FIRST LEVEL. PATHWAYS SHALL BE PROVIDED AT UPPER LEVELS, WHEREVER POSSIBLE.
- 4 - EQUIPMENT AND COMPONENTS SUBJECT TO LEAKAGE OR OVERFLOW OF COMBUSTIBLE AND/OR FLAMMABLE LIQUID, CONTAMINATED LIQUIDS AND CHEMICALS SHALL HAVE COLLECTING BASIN (PLATE HEIGHT = 150 mm) AND DRAINAGE.
- 5 - SUPPLIER SHALL REVIEW AND ADJUST THE MODULES DESIGN, INCLUDING ELEVATIONS AND HEIGHTS, IN ORDER TO ALLOW PROPER MAINTENANCE, OPERATION AND ACCESS TO EQUIPMENT AND PIPING.
- 6 - DETAILING DESIGN IS RESPONSIBLE FOR FINAL PIPING ARRANGEMENT, ACCORDING TO VENDOR EQUIPMENT DIMENSIONS, NOZZLE POSITIONS, PIPING SUPPORT REQUIREMENTS AND PIPING FLEXIBILITY ANALYSIS.
- 7 - DECK MODULES REQUIRED ELEVATIONS WERE NOT YET DEFINED. ADDITIONAL DECKS MAY BE REQUIRED IN SOME MODULES DUE TO PIPING INSTALLATION.
- 8 - HANDLING STUDIES AND PIPE ROUTING WERE NOT DONE AT THIS PHASE AND MAY AFFECT MODULES FOOTPRINT.
- 9 - STAIRS POSITIONS ARE PRELIMINARY.

HOLDS LIST

1. ALL EQUIPMENT DIMENSIONS.
2. FIRE HYDRANT & LOCKERS QUANTITY & LOCATIONS.
3. ACCESS PLATFORM ELEVATIONS AND DIMENSIONS.
4. PLATING AND GRATING REQUIREMENT FOR THE DECKS.
5. MONORAIL CAPACITY, DESIGN, ELEVATION AND TAG NUMBERS.
6. LAYDOWN AND HATCH OPENING SIZE.
7. COAMING REQUIREMENT WITH COLLECTION BASIN.
8. THE INTERCONNECTION BETWEEN MODULE TO MODULE / PIPERACK.
9. TOPSIDE / HULL SCOPE LIMIT.
10. ELECTRICAL AND AUTOMATION EQUIPMENT LOCATION.
11. AFT CRANE FREEDOM HEIGHT.
12. ACCOMMODATIONS AND HULL AREAS LAYOUT.
13. ELEVATIONS OF MODULE M-09 AND PIPERACK.

LEGEND



MAIN CHARACTERISTICS

HULL LENGTH OVERALL	345.30 m.
BREADTH (MOULDED)	64.80m.
DEPTH AT SIDE SHELL (MOULDED)	33.80 m.
DEPTH AT CENTER LINE (MOULDED)	34.30 m.

KEY PLAN

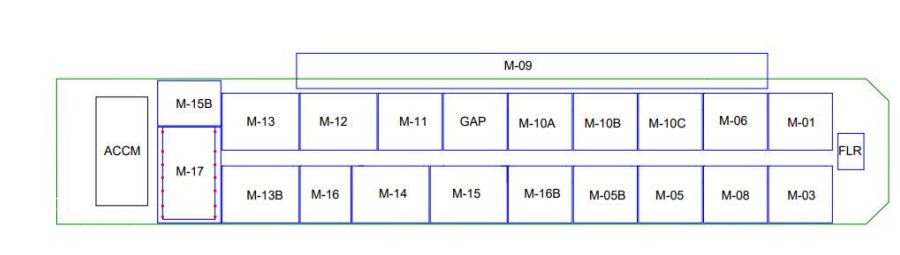

REV	DESCRIPTION	DATE	DESIGN	CHECK	APPROV.
A	GENERAL REVISION	20/04/2024	F331	R1.01	U22N
U	ORIGINAL ISSUE	20/05/2023	R1.01	CSPA	U22N

INFORMATION IN THIS DOCUMENT IS PROPERTY OF PETROBRAS, BEING PROHIBITED OUTSIDE OF THE COMPANY'S PREMISES.

PETROBRAS BRGE

CLIENT: **MARLIM LESTE E SUL**

JOB: **BASIC DESIGN - REVIT1**

AREA: **MARLIM LESTE E SUL**

TITLE: **GENERAL ARRANGEMENT**

DESIGN: ESUP
SCALE: 500
INTERNAL: ESUP

DATE: 20/05/2023

PROJECT: I-DE-3010.2Q-1200-942-P4X-002

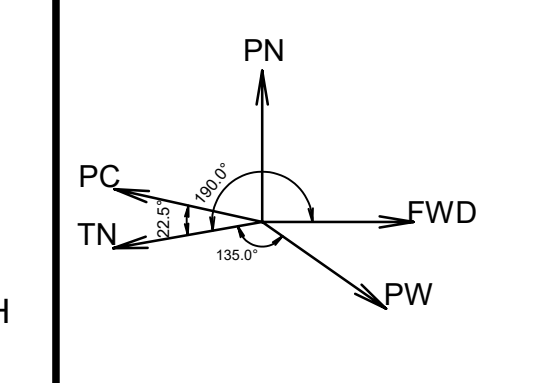

MODULE TAG	MODULE DESCRIPTION
M-01	FLARE SYSTEM
M-03	EXPORT GAS COMPRESSION
M-05	MAIN GAS COMPRESSION
M-06	GAS DEHYDRATION AND FUEL GAS
M-08	H2S REMOVAL SYSTEM
M-09	PIG LAUNCHERS/RECEIVERS AND PRODUCTION & INJECTION MANIFOLDS
M-10A	OIL PROCESSING AND WELL SERVICE
M-10B	PRODUCED WATER TREATMENT AND TEST SEPARATOR
M-10C	OIL PROCESSING
M-11	WATER INJECTION AND SULPHATE REMOVAL UNIT
M-12	POWER GENERATION
M-13	POWER GENERATION
M-13B	POWER GENERATION
M-14	CHEMICAL UNIT, PRODUCTS STORAGE AND UTILITIES
M-15	UTILITIES
M-15B	HULL UTILITIES
M-16	LAYDOWN AREA
M-16B	LAYDOWN AREA AND SUBMARINE PUMPING UNIT
M-17	AUTOMATION AND ELECTRICAL

REFERENCE DOCUMENTS

I-LI-3010.2Q-1200-940-P4X-002 - EQUIPMENT LIST

GENERAL NOTES

- 1 - DIMENSIONS ARE IN MILLIMETERS, EXCEPT WHERE INDICATED.
- 2 - EQUIPMENT DIMENSIONS ARE PRELIMINARY.
- 3 - CONTIGUOUS INTERCONNECTION BETWEEN MODULES, MODULES/ACCOMMODATIONS AND MODULES FORECASTLE SHALL BE PROVIDED AT THE FIRST LEVEL. PATHWAYS SHALL BE PROVIDED AT UPPER LEVELS, WHEREVER POSSIBLE.
- 4 - EQUIPMENT AND COMPONENTS SUBJECT TO LEAKAGE OR OVERFLOW OF COMBUSTIBLE AND/OR FLAMMABLE LIQUID, CONTAMINATED LIQUIDS AND CHEMICALS SHALL HAVE COLLECTING BASIN (PLATE HEIGHT = 150 mm) AND DRAINAGE.
- 5 - SUPPLIER SHALL REVIEW AND ADJUST THE MODULES DESIGN, INCLUDING ELEVATIONS AND HEIGHTS, IN ORDER TO ALLOW PROPER MAINTENANCE, OPERATION AND ACCESS TO EQUIPMENT AND PIPING.
- 6 - DETAILING DESIGN IS RESPONSIBLE FOR FINAL PIPING ARRANGEMENT, ACCORDING TO VENDOR EQUIPMENT DIMENSIONS, NOZZLE POSITIONS, PIPING SUPPORT REQUIREMENTS AND PIPING FLEXIBILITY ANALYSIS.
- 7 - DECK MODULES REQUIRED ELEVATIONS WERE NOT YET DEFINED. ADDITIONAL DECKS MAY BE REQUIRED IN SOME MODULES DUE TO PIPING INSTALLATION.
- 8 - HANDLING STUDIES AND PIPE ROUTING WERE NOT DONE AT THIS PHASE AND MAY AFFECT MODULES FOOTPRINT.
- 9 - STAIRS POSITIONS ARE PRELIMINARY.

HOLDS LIST

1. ALL EQUIPMENT DIMENSIONS.
2. FIRE HYDRANT & LOCKERS QUANTITY & LOCATIONS.
3. ACCESS PLATFORM ELEVATIONS AND DIMENSIONS.
4. PLATING AND GRATING REQUIREMENT FOR THE DECKS.
5. MONORAIL CAPACITY, DESIGN, ELEVATION AND TAG NUMBERS.
6. LAYDOWN AND HATCH OPENING SIZE.
7. COAMING REQUIREMENT WITH COLLECTION BASIN.
8. THE INTERCONNECTION BETWEEN MODULE TO MODULE / PIPERACK.
9. TOPSIDE / HULL SCOPE LIMIT.
10. ELECTRICAL AND AUTOMATION EQUIPMENT LOCATION.
11. AFT CRANE FEEDSTOCK HEIGHT.
12. ACCOMMODATIONS AND HULL AREAS LAYOUT.
13. ELEVATIONS OF MODULE M-09 AND PIPERACK.

LEGEND

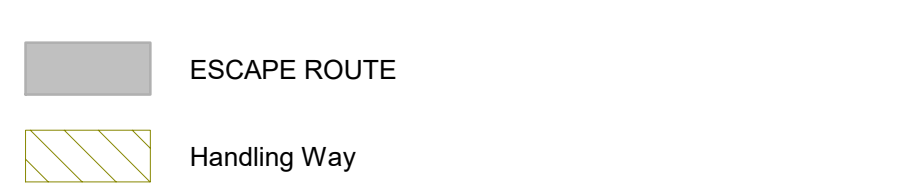

MAIN CHARACTERISTICS

HULL LENGTH OVERALL	345.30 m.
BREADTH (MOULDED)	64.80m.
DEPTH AT SIDE SHELL (MOULDED)	33.80 m.
DEPTH AT CENTER LINE (MOULDED)	34.30 m.

KEY PLAN

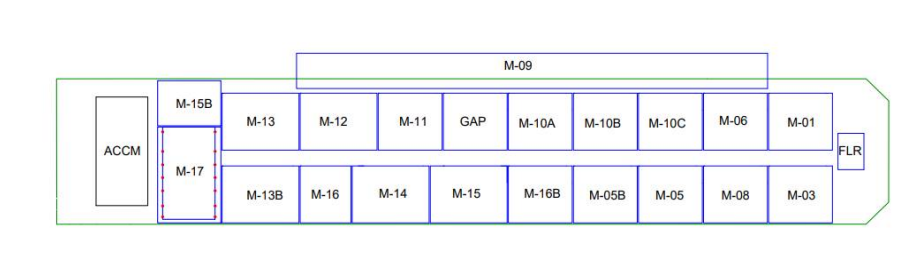

REV	DESCRIPTION	DATE	ENGR	CHECK	APPROV
A	GENERAL REVISION	20/04/2024	F330	R1.00	U02N
0	ORIGINAL ISSUE	20/02/2023	R1.00	CSPA	U02N

INFORMATION IN THIS DOCUMENT IS PROPERTY OF PETROBRAS, BEING PROHIBITED OUTSIDE OF THE COMPANY'S PREMISES.

FORM OWNED BY PETROBRAS N-381 REV. L



CLIENT: MARLIM LESTE E SUL

JOB: BASIC DESIGN - REVIT1

AREA: MARLIM LESTE E SUL

TITLE: GENERAL ARRANGEMENT

DESIGN	ESUP	ENGR	RL30	CHECK	CSPA	APPROV	U02N
SCALE	1:500	DRAWING					
INTERNAL							

DATE: AUG25/2023

NO: I-DE-3010.2Q-1200-942-P4X-002

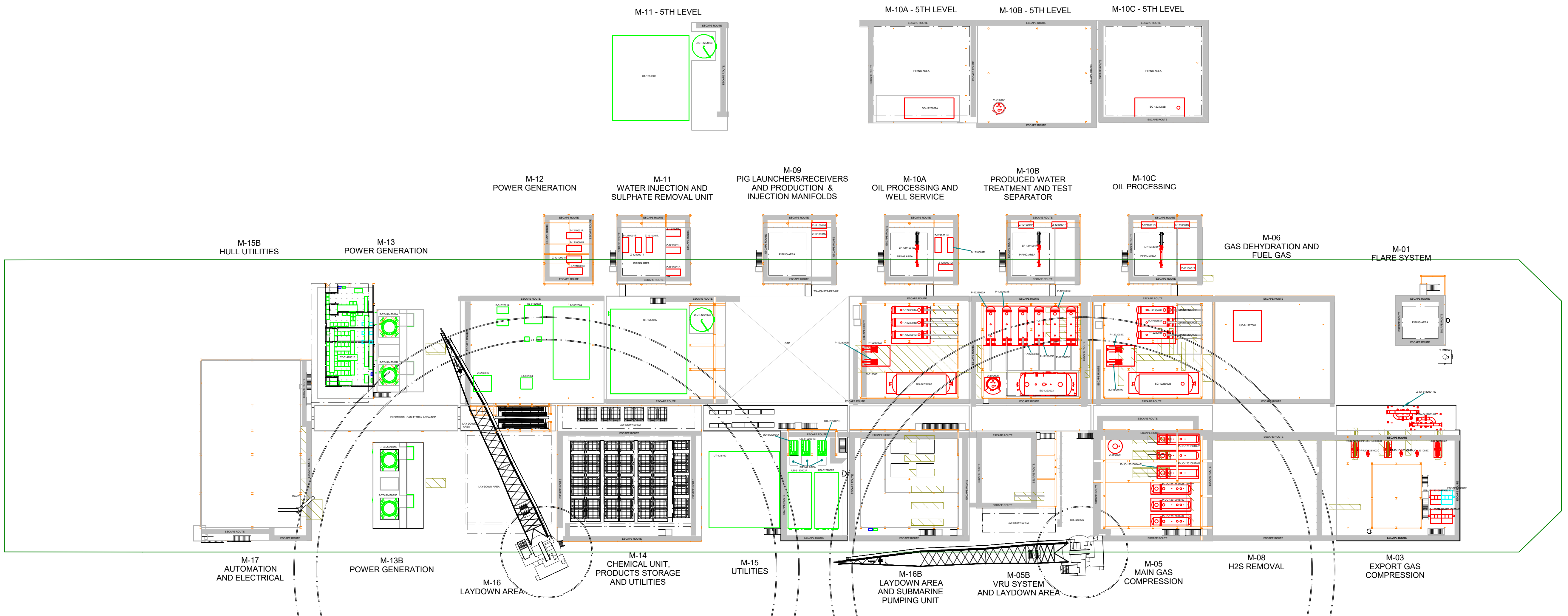

PRODUCTION PLANT - 4TH LEVEL
(SCALE: 1:500 mm)

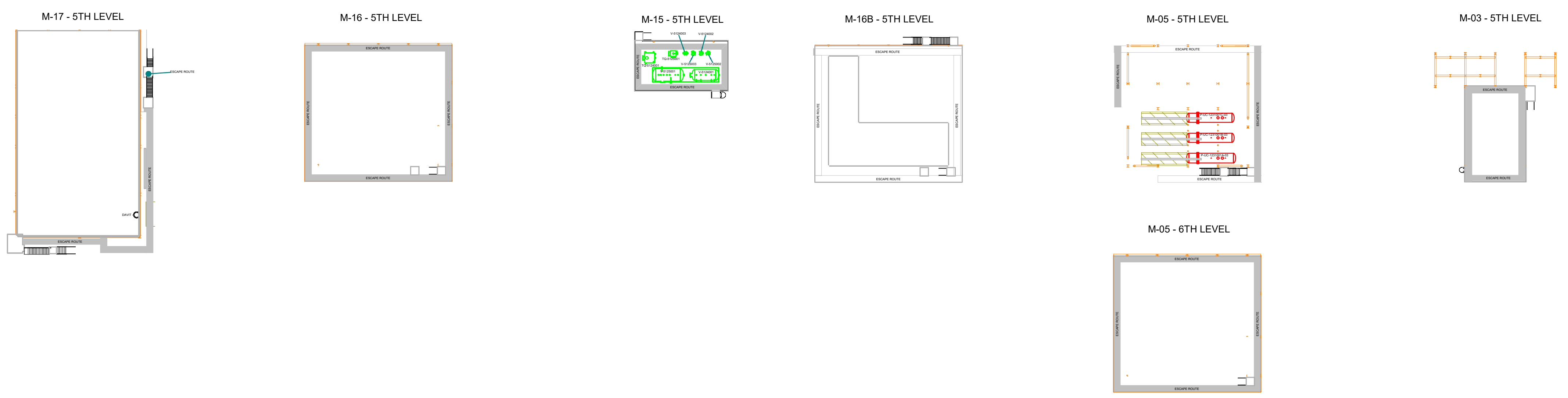

PRODUCTION PLANT - 3rd LEVEL
(SCALE: 1:500 mm)

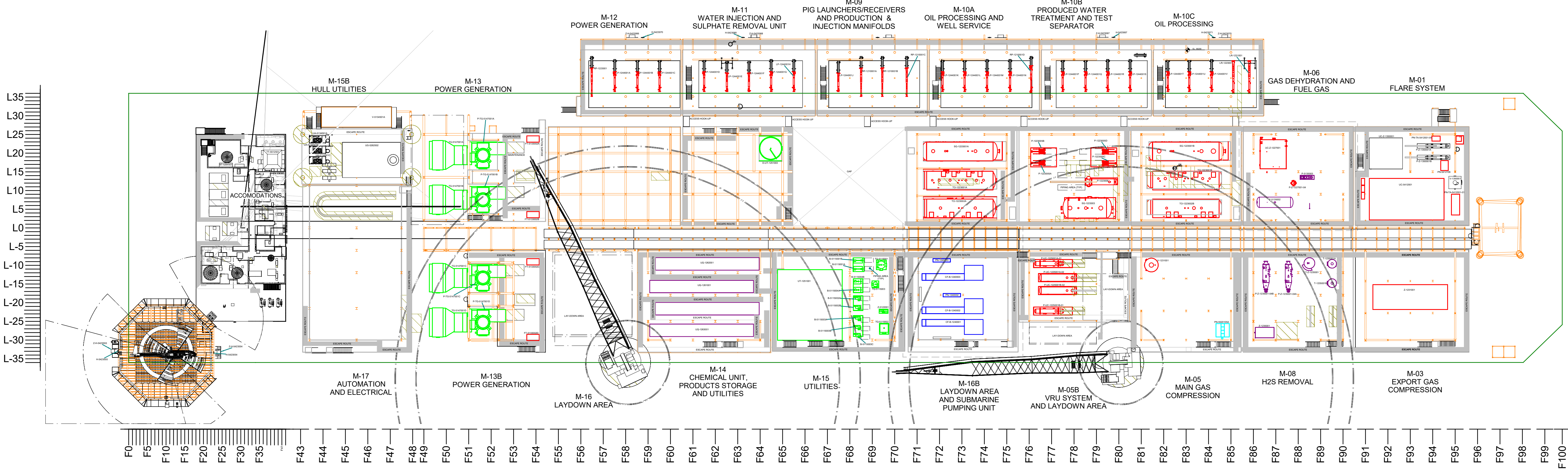

MODULE TAG	MODULE DESCRIPTION
M-01	FLARE SYSTEM
M-03	EXPORT GAS COMPRESSION
M-05	MAIN GAS COMPRESSION
M-05B	VRU SYSTEM AND LAYDOWN AREA
M-06	GAS DEHYDRATION AND FUEL GAS
M-08	H2S REMOVAL SYSTEM
M-09	PIG LAUNCHERS/RECEIVERS AND PRODUCTION & INJECTION MANIFOLDS
M-10A	OIL PROCESSING AND WELL SERVICE
M-10B	PRODUCED WATER TREATMENT AND TEST SEPARATOR
M-10C	OIL PROCESSING
M-11	WATER INJECTION AND SULPHATE REMOVAL UNIT
M-12	POWER GENERATION
M-13	POWER GENERATION
M-13B	POWER GENERATION
M-14	CHEMICAL UNIT, PRODUCTS STORAGE AND UTILITIES
M-15	UTILITIES
M-15B	HULL UTILITIES
M-16	LAYDOWN AREA
M-16B	LAYDOWN AREA AND SUBMARINE PUMPING UNIT
M-17	AUTOMATION AND ELECTRICAL

REFERENCE DOCUMENTS

- HLI-3010.2Q-1200-940-P4X-002 - EQUIPMENT LIST
- GENERAL NOTES
- 1 - DIMENSIONS ARE IN MILLIMETERS, EXCEPT WHERE INDICATED.
 - 2 - EQUIPMENT DIMENSIONS ARE PRELIMINARY.
 - 3 - CONTIGUOUS INTERCONNECTION BETWEEN MODULES, MODULES/ACCOMMODATIONS AND MODULES FORECASTLE SHALL BE PROVIDED AT THE FIRST LEVEL. PATHWAYS SHALL BE PROVIDED AT UPPER LEVELS, WHEREVER POSSIBLE.
 - 4 - EQUIPMENT AND COMPONENTS SUBJECT TO LEAKAGE OR OVERFLOW OF COMBUSTIBLE AND/OR FLAMMABLE LIQUID, CONTAMINATED LIQUIDS AND CHEMICALS SHALL HAVE COLLECTING BASIN (PLATE HEIGHT = 150 mm) AND DRAINAGE.
 - 5 - SUPPLIER SHALL REVIEW AND ADJUST THE MODULES DESIGN, INCLUDING ELEVATIONS AND HEIGHTS, IN ORDER TO ALLOW PROPER MAINTENANCE, OPERATION AND ACCESS TO EQUIPMENT AND PIPING.
 - 6 - DETAILING DESIGN IS RESPONSIBLE FOR FINAL PIPING ARRANGEMENT, ACCORDING TO VENDOR EQUIPMENT DIMENSIONS, NOZZLE POSITIONS, PIPING SUPPORT REQUIREMENTS AND PIPING FLEXIBILITY ANALYSIS.
 - 7 - DECK MODULES REQUIRED ELEVATIONS WERE NOT YET DEFINED. ADDITIONAL DECKS MAY BE REQUIRED IN SOME MODULES DUE TO PIPING INSTALLATION.
 - 8 - HANDLING STUDIES AND PIPE ROUTING WERE NOT DONE AT THIS PHASE AND MAY AFFECT MODULES FOOTPRINT.
 - 9 - STAIRS POSITIONS ARE PRELIMINARY.

- HOLDS LIST
1. ALL EQUIPMENT DIMENSIONS.
 2. FIRE HYDRANT & LOCKERS QUANTITY & LOCATIONS.
 3. ACCESS PLATFORM ELEVATIONS AND DIMENSIONS.
 4. PLATING AND GRATING REQUIREMENT FOR THE DECKS.
 5. MONORAIL CAPACITY, DESIGN, ELEVATION AND TAG NUMBERS.
 6. LAYDOWN AND HATCH OPENING SIZE.
 7. COAMING REQUIREMENT WITH COLLECTION BASIN.
 8. THE INTERCONNECTION BETWEEN MODULE TO MODULE / PIPERACK.
 9. TOPSIDE / HULL SCOPE LIMIT.
 10. ELECTRICAL AND AUTOMATION EQUIPMENT LOCATION.
 11. AFT CRANE ELEVATION AND TAG NUMBERS.
 12. ACCOMMODATIONS AND HULL AREAS LAYOUT.
 13. ELEVATIONS OF MODULE M-09 AND PIPERACK.

- LEGEND
- ESCAPE ROUTE
 - Handling Way

MAIN CHARACTERISTICS

HULL LENGTH OVERALL	345.30 m.
BREADTH (MOULDED)	64.80m.
DEPTH AT SIDE SHELL (MOULDED)	33.80 m.
DEPTH AT CENTER LINE (MOULDED)	34.30 m.

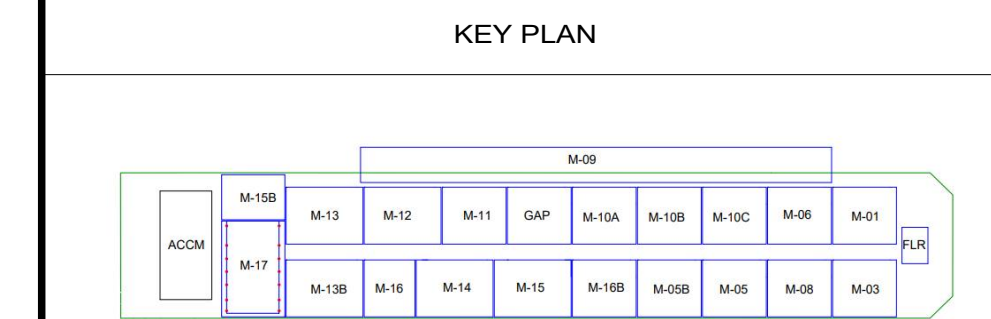

REV	DESCRIPTION	DATE	EXEC	CHECK	APPROV
A	GENERAL REVISION	2024/02/24	F331	R1.05	LU2N
0	ORIGINAL ISSUE	2023/09/08	R1.02	CSPA	LU2N

INFORMATION IN THIS DOCUMENT IS PROPERTY OF PETROBRAS, BEING PROHIBITED OUTSIDE OF THEIR PURPOSE.

FORM OWNED BY PETROBRAS N-381 REV. L.

PETROBRAS BRGE

CLIENT: MARLIM LESTE E SUL

JOB: BASIC DESIGN - REVIT1

AREA: MARLIM LESTE E SUL

TITLE: GENERAL ARRANGEMENT

DESIGN	ESUP	EXEC	ELJO	CHECK	CSPA	APPROV	LU2N
SCALE	500	DRAWING					
INTERNAL		ESUP					

DATE: AUG25/2023 No: I-DE-3010 2Q-1200-942-P4X-002

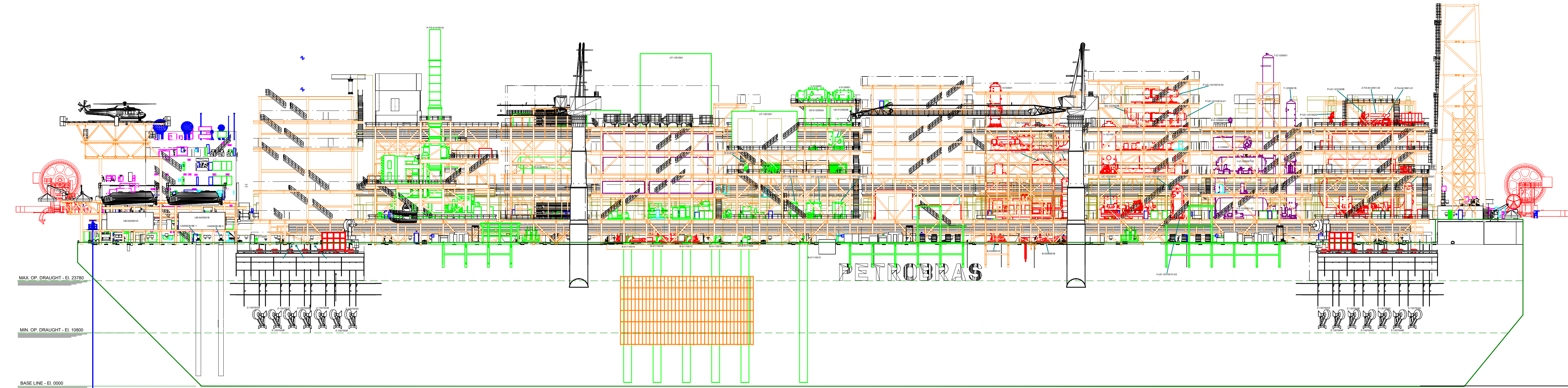

SIDE VIEW (STARBOARD)
(SCALE: 1:500 mm)

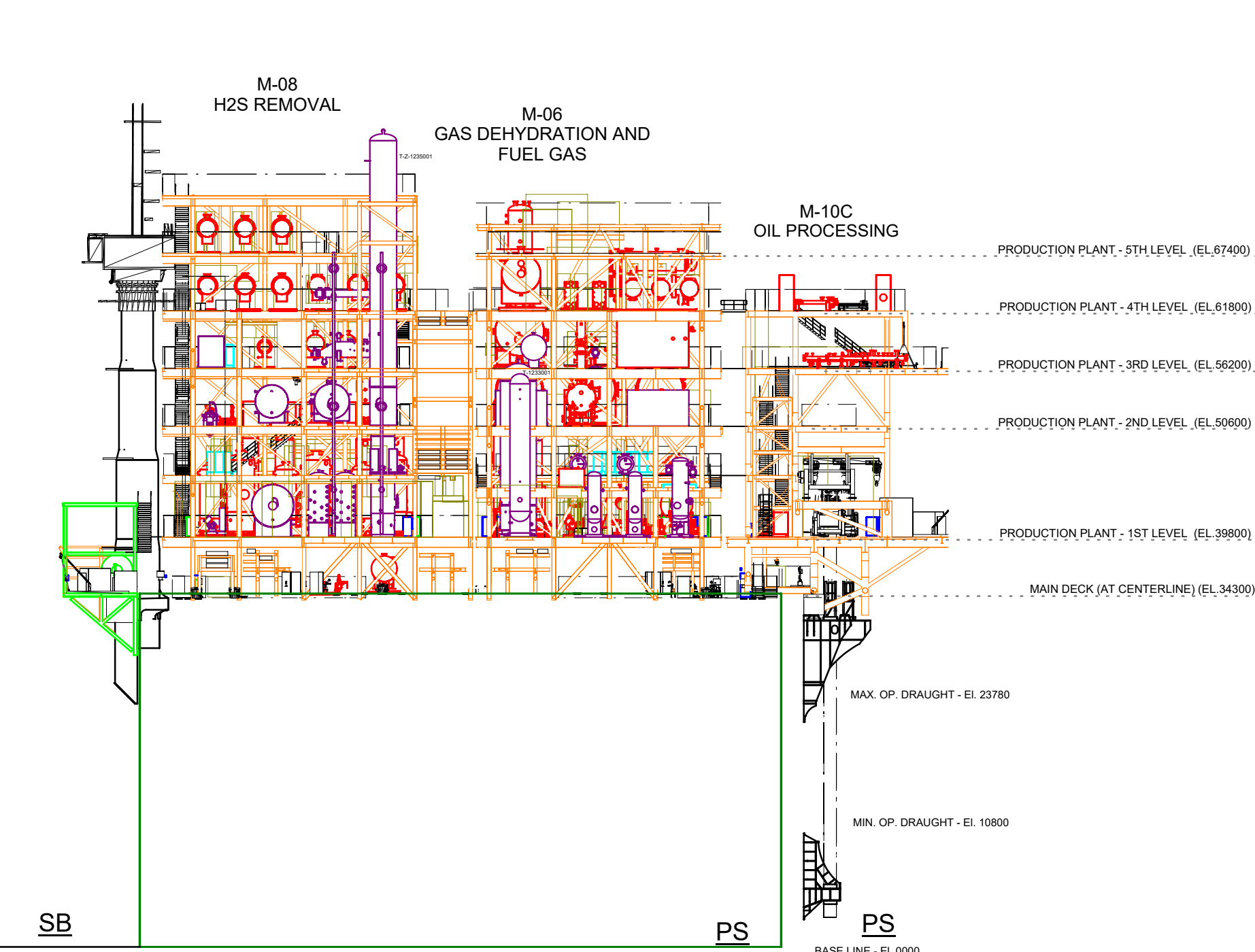

FRONT VIEW (SECTION)
(SCALE: 1:500 mm)

